

# AVAILABLE FOR LEASE

2825 POTTSVILLE PIKE (CENTRE AVENUE)  
READING (MUHLENBERG), PA 19605



Property Size	31,102 Sq. Ft.
Building Size	640 Sq. Ft.
Annual Taxes	\$ 5,051
Annual Rent (NNN)	\$50,000
Tax ID	PIN # 66-5308-11-65-0335
Zoning	C-3 - HIGHWAY COMMERCIAL

## For Additional Information Contact

ED DELANEY  
OFFICE PHONE # 732-225-2212  
CELL PHONE # 908-216-2493  
EMAIL: edelaney@gettyrealty.com

*The information contained herein while believed to be accurate is not warranted or represented by  
Getty Realty Corp.*

69002

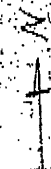

DATE: 6-12-54  
 DRAWN BY: [illegible]  
 CHECKED BY: [illegible]  
 PROJECT: [illegible]  
 SHEET NO. [illegible] OF [illegible]  
 JOB NO. [illegible]

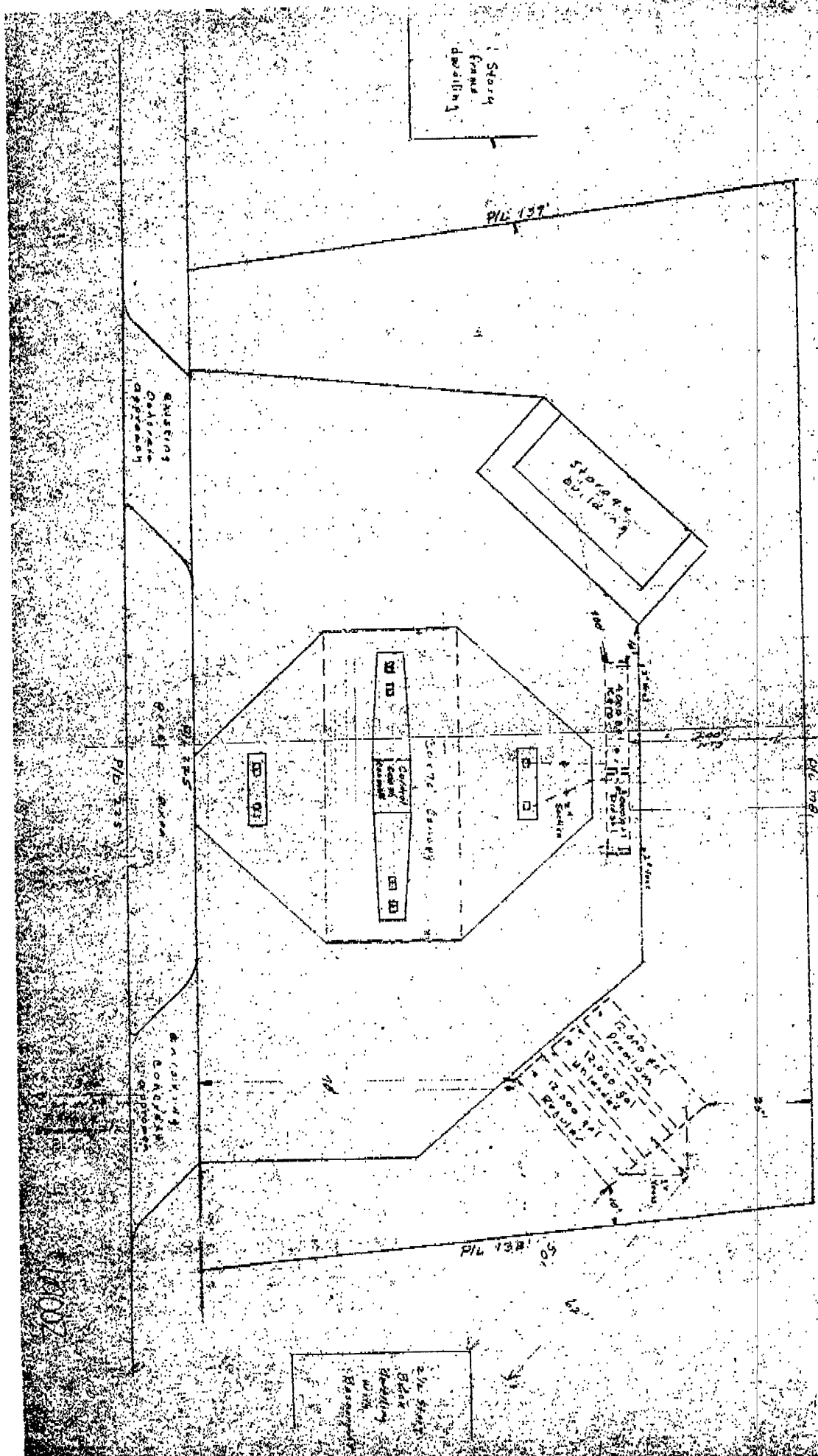

69002